

# N - SMA系列间转换器

主要性能指标		材料/表面处理	
特性阻抗	50Ω	壳体	不锈钢SU303 钝化
频率范围	DC ~ 18GHz	内导体	镀铜 镀金
连接器耐久性	≥500次	绝缘体	PEI&PTFE
温度范围	-60℃~+165℃		

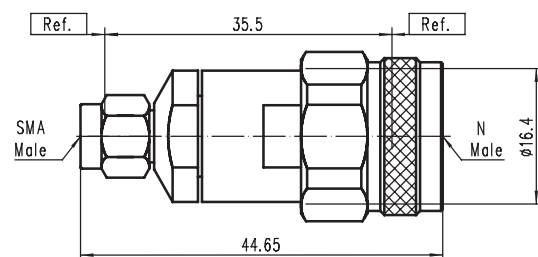

CODE: 100028

TYPE: N / SMA - JJG

VSWR: DC - 18GHz...1.15 : 1(max)

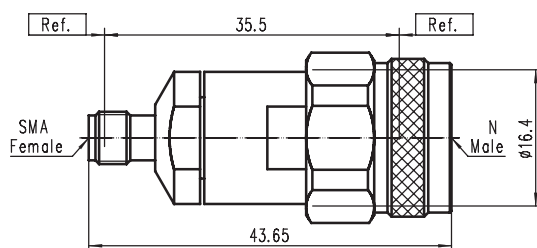

CODE: 100029

TYPE: N / SMA - JKG

VSWR: DC - 18GHz...1.15 : 1(max)

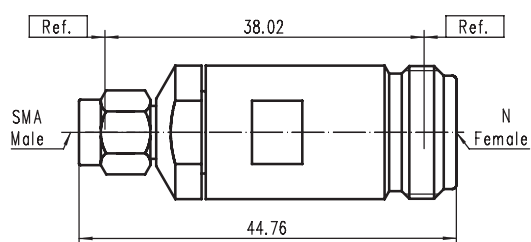

CODE: 100030

TYPE: N / SMA - KJG

VSWR: DC - 18GHz...1.15 : 1(max)

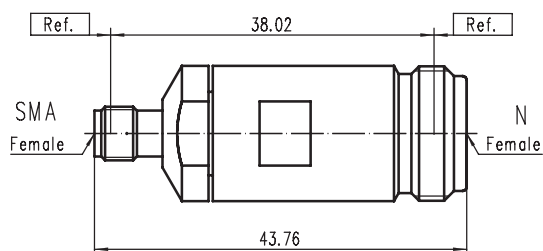

CODE: 100031

TYPE: N / SMA - KKG

VSWR: DC - 18GHz...1.15 : 1(max)